

BOX HILL-MT. CARMEL ROAD ROAD DESIGN

CONCEPT DESIGN

DRAWING LIST

No.	Drawing Title
GENERAL	
000	COVER SHEET
001	GENERAL NOTES & LEGEND
002	TYPICAL CROSS SECTIONS
ROADWORKS	
100	GENERAL LAYOUT PLAN
101	ENGINEERING PLAN SHEET 1 OF 6 INTERSECTION 01 (SIGNALISED)
102	ENGINEERING PLAN SHEET 2 OF 6 WINDSOR ROAD EAST
103	ENGINEERING PLAN SHEET 3 OF 6 ENTRY ROAD CH0- CH375
104	ENGINEERING PLAN SHEET 4 OF 6 ENTRY ROAD CH375 - CH720
105	ENGINEERING PLAN SHEET 5 OF 6 ENTRY ROAD CH720 - CH1080
106	ENGINEERING PLAN SHEET 6 OF 6 ENTRY ROAD CH1080 - CH1200.5
401	TURNING PATH DIAGRAM INTERSECTION 01
STRUCTURAL DETAILS	
901	BRIDGE CONCEPT
903	STRUCTURAL BRIDGE DETAIL SHEET 1 OF 1



LOCALITY PLAN
N.T.S.

THE HILLS SHIRE COUNCIL



MOGUL STUD/JUNDU PTY LTD

MT CARMEL ROAD

BOX HILL - MT CARMEL ROAD



Project No.: X11295.01 Stage: Milestone: CD Drawing No.: 000 Revision: 00

STANDARD NOTES

GENERAL NOTES

- G1 ALL WORK TO BE CARRIED OUT IN ACCORDANCE WITH THE HILLS SHIRE COUNCIL'S WORKS SPECIFICATION SUBDIVISIONS / DEVELOPMENTS AND TO THE REQUIREMENTS OF THE CERTIFYING AUTHORITY.
- G2 INSPECTIONS BY CERTIFYING AUTHORITY ARE REQUIRED AT THE FOLLOWING STAGES AND THE WORKS APPROVED PRIOR TO CONTINUANCE OF ANY FUTURE WORK:
- (A) PRIOR TO COMMENCEMENT OF WORKS.
FOLLOWING INSTALLATION OF EROSION AND SEDIMENT CONTROL STRUCTURES / MEASURES.
- (B) TRAFFIC CONTROL MEASURES TO AS 1742.3 PRIOR TO OPENING OF ROADS.
- (C) PRIOR TO BACKFILLING PIPELINES, SUBSOIL DRAINS AND DAMS.
- (D) PRIOR TO CASTING OF PITS AND OTHER CONCRETE STRUCTURES, INCLUDING KERB AND GUTTER BUT FOLLOWING PLACEMENT OF FOOTINGS, FORMWORK, AND REINFORCEMENT.
- (E) PRIOR TO PLACEMENT OF SUB BASE AND ALL SUBSEQUENT PAVEMENT LAYERS, A PROOF ROLLER TEST OF EACH PAVEMENT LAYER IS REQUIRED.
- (F) FORMWORKS PRIOR TO POURING CONCRETE IN PARKING AREA FOR FOOTPATH CROSSING AND OTHER ASSOCIATED WORK.
- (G) PRIOR TO THE PLACEMENT OF FILL TO SITE REGRADE AREAS, INSPECTION OF FILL MATERIAL REQUIRED.
- (H) PRIOR TO BACKFILLING PUBLIC UTILITY CROSSINGS IN ROAD RESERVES.
- (I) FINAL INSPECTIONS AFTER ALL WORKS ARE COMPLETED AND 'WORKS AS EXECUTED' PLANS HAVE BEEN SUBMITTED TO COUNCIL.
- (J) LAYING OF ASPHALTIC CONCRETE SURFACE.
- G3 NO TREES ARE TO BE REMOVED UNLESS APPROVAL IS GRANTED BY COUNCIL'S ENGINEER.
- G4 MAKE SMOOTH JUNCTIONS WITH EXISTING WORKS.
- G5 NO WORK IS TO BE CARRIED OUT ON COUNCIL PROPERTY OR ADJOINING PROPERTIES WITHOUT THE WRITTEN PERMISSION FROM THE OWNER/S.
- G6 VEHICULAR ACCESS AND ALL UTILITIES/SERVICES ARE TO BE MAINTAINED AT ALL TIMES TO ADJOINING PROPERTIES AFFECTED BY CONSTRUCTION.
- G7 ALL RUBBISH, BUILDINGS, SHEDS AND FENCES TO BE REMOVED TO SATISFACTION OF COUNCIL'S ENGINEER.

EARTHWORKS NOTES

- E1 EARTHWORKS ARE TO BE CARRIED OUT TO THE SATISFACTION OF THE COUNCIL. UNSUITABLE MATERIALS ARE TO BE REMOVED FROM ROADS AND LOTS PRIOR TO FILLING. THE CONTRACTOR IS TO ARRANGE AND MAKE AVAILABLE COMPACTION TESTING RESULTS FOR ALL AREAS THAT CONTAIN FILL IN EXCESS OF 200 mm.
- E2 COMPACTION OF EARTHWORKS SHALL CONTINUE UNTIL A DRY DENSITY RATIO OF 95% FOR SITE FILLING AND 100% FOR ROAD PAVEMENT SUBGRADES HAS BEEN ACHIEVED IN ACCORDANCE WITH TEST METHOD AS1289.5.2.1 OR AS.1289.5.1.1. THE CONTROL TESTING OF EARTHWORKS SHALL BE IN ACCORDANCE WITH THE GUIDELINES IN AS3798 'GUIDELINES ON EARTHWORKS FOR COMMERCIAL AND RESIDENTIAL IN ACCORDANCE WITH THE HILLS SHIRE COUNCIL'S WORKS SPECIFICATION SUBDIVISIONS / DEVELOPMENTS
- E3 THE SUITABLE QUALIFIED GEOTECHNICAL ENGINEER, SHALL HAVE A LEVEL 1 RESPONSIBILITY FOR ALL FILLING AS DEFINED IN APPENDIX B AS3798 'GUIDELINES ON EARTHWORKS FOR COMMERCIAL AND RESIDENTIAL DEVELOPMENTS', AND AT THE END OF THE WORKS SHALL CONFIRM THE EARTHWORKS COMPLY WITH THE REQUIREMENTS OF THE SPECIFICATION AND DRAWINGS BY WRITTEN NOTIFICATION.
- E4 IN AREAS TO BE FILLED WHERE THE SLOPE OF THE NATURAL SURFACE EXCEEDS 1(V):4(H), BENCHES ARE TO BE CUT TO PREVENT SLIPPING OF THE PLACED FILL MATERIAL AS REQUIRED BY THE COUNCIL.
- E5 ALL BATTERS ARE TO BE SCARIFIED TO A DEPTH OF 50 mm TO ASSIST WITH ADHESION OF TOP SOIL TO BATTER FACE.
- E6 PROVIDE MINIMUM 150 mm AND MAXIMUM 300 mm TOPSOIL WITHIN FOOTPATHS, FILLED AREAS AND ALL OTHER AREAS DISTURBED DURING CONSTRUCTION. TOPSOILED AREAS TO BE STABILISED WITH APPROVED VEGETATION A MAXIMUM OF 14 DAYS AFTER TOPSOILING AND ARE TO BE WATERED TO ENSURE GERMINATION.
- E7 THE CONTRACTOR SHALL CONTROL SEDIMENTATION, EROSION AND POLLUTION DURING CONSTRUCTION IN ACCORDANCE WITH THE REQUIREMENTS OF THE CURRENT EDITION OF 'MANAGING URBAN STORMWATER: SOILS AND CONSTRUCTION' PRODUCED BY LANDCOM.
- E8 A MINIMUM 1 METRE WIDE, CONTINUOUS STRIP OF COUCH GRASS SHALL BE PLACED BEHIND THE BACK OF ALL KERBS AND OTHER CONCRETE STRUCTURES IMMEDIATELY AFTER THE COMPLETION OF THE FOOTPATH GRADING OR OTHER ELEMENTS AS APPLICABLE, AND SHALL BE MAINTAINED AND REPLACED AS REQUIRED DURING THE CONSTRUCTION MAINTENANCE PERIOD.

ROADWORKS NOTES

- R1 SUBGRADES AND SUB BASES ARE TO BE COMPACTED IN ACCORDANCE WITH COUNCIL'S CONSTRUCTION SPECIFICATION.
- R2 SUBSOIL DRAINS TO BE PROVIDED ON BOTH SIDES OF ROADS (EXCEPT WHERE THERE IS STORMWATER DRAINAGE), OR AS DIRECTED BY COUNCIL'S ENGINEER.
- R3 150 X 50 H.D. GALVANISED STEEL KERB OUTLETS TO BE PLACED IN ALL KERB TYPES ON LOW SIDE OF LOTS. PROVIDE SUITABLE ADAPTOR TO ALLOW CONNECTION OF 90 mm DIAMETER STORMWATER PIPE.
- R4 LIPLESS PERAMBULATOR CROSSINGS ARE TO BE PROVIDED IN ALL KERB RETURNS AND WHERE REQUIRED BY COUNCIL.
- R5 SERVICE CONDUITS TO BE PLACED AS DIRECTED BY ALL PUBLIC UTILITY AUTHORITIES INCLUDING ENDEAVOUR ENERGY, TELSTRA AND SYDNEY WATER.
- R6 PROPOSED UTILITIES AND SERVICES CROSSING EXISTING ROADS SHALL BE PROVIDED FOR USING A TRENCHLESS TECHNIQUE SO AS NOT TO DAMAGE THE EXISTING SURFACE. ALL SERVICE CONDUITS UNDER ROADS MUST BE LAID TO A MINIMUM DEPTH OF 750 mm.
- R7 CONCRETE FOOTPATH CONSTRUCTION IS TO BE CONSTRUCTED ON COMPLETION OF UTILITY/SERVICES AND SURROUNDING DWELLINGS.
- R8 ALL TEMPORARY ROADS MUST BE TEMPORARILY SEALED WITH A SINGLE COAT FLUSH SEAL.
- R9 ALL PERMANENT ROADS ARE TO BE SEALED WITH 50 mm OF AC TO BE APPLIED IN TWO 25 mm THICK LAYERS. THE FINAL AC LAYER IS TO BE AC 10 AND IS TO BE BONDED AND PLACED FOLLOWING APPROVAL FROM COUNCIL.
- R10 SIGNPOSTING AND LINE MARKING SHALL CONFORM TO AS1742.2 'TRAFFIC CONTROL DEVICES FOR GENERAL USE': RAISED RETRO-REFLECTIVE PAVEMENT MARKERS TO CONFORM TO AS1906 'RETRO-REFLECTIVE MATERIALS AND DEVICES FOR ROAD 'TRAFFIC CONTROL PURPOSES': ALL APRONS AND KERB FACE ON CENTRAL ISLANDS OF ROUNDABOUTS AND ALL OTHER ISLANDS TO BE DELINEATED BY REFLECTIVE WHITE MARKING. INSTALLATION SHALL OCCUR IN ACCORDANCE WITH THE PLAN APPROVED BY THE LOCAL TRAFFIC COMMITTEE.
- R11 ALL LOT NUMBERS MUST BE STENCILLED ON KERB FACE.
- R12 STREET SIGNS TO COUNCIL STANDARD MUST BE INSTALLED BY THE CONTRACTOR. THE HILLS SHIRE COUNCIL'S WORKS SPECIFICATION SUBDIVISIONS / DEVELOPMENTS

STORMWATER NOTES

- S1 ALL PIPES TO BE SPIGOT AND SOCKET, RUBBER RING JOINTED.
- S2 ALL LONGITUDINAL PIPELINES IN ROADS MUST BE LOCATED UNDER KERB AND GUTTER AND BE BACKFILLED WITH APPROVED GRANULAR MATERIAL UNLESS OTHERWISE APPROVED BY THE COUNCIL ENGINEER.
- S3 DRAINAGE LINES MUST BE BACKFILLED WITH APPROVED GRANULAR MATERIAL IN TRAFFICABLE AREAS. THREE (3) METRES OF SUBSOIL DRAINAGE WRAPPED IN GEOTEXTILE STOCKING MUST BE PROVIDED TO ALL DOWNSTREAM PITS.
- S4 ALL GULLY PITS TO COUNCIL'S STANDARD AND LINTELS CENTRALLY PLACED AT SAG PITS.
- S5 ALL PITS MUST BE BENCHED AND STREAMLINED. PROVIDE GALVANISED STEP IRONS IN ALL PITS OVER 1.2-METRES DEEP AS MEASURED FROM THE TOP OF GRATE TO THE INVERT OF THE PIT AND REINFORCEMENT FOR PITS OVER 1.8 m DEEP.
- S6 CONCRETE IS TO HAVE MINIMUM COMPRESSIVE STRENGTH OF 32 MPa AT 28-DAYS UNLESS OTHERWISE APPROVED BY THE COUNCIL ENGINEER.
- S7 ALL INTERALLOTMENT DRAINAGE MUST HAVE A MINIMUM PIPE DIAMETER OF 150 mm AND A MINIMUM GRADE OF 1% UNLESS OTHERWISE APPROVED BY THE COUNCIL ENGINEER.
- S8 ALL INTERALLOTMENT DRAINAGE LINES MUST BE LAID CENTRALLY WITHIN DRAINAGE EASEMENTS. INSPECTION PITS MUST BE PROVIDED AT ALL CHANGES OF GRADE AND DIRECTION.
- S9 INTERALLOTMENT DRAINAGE LINES MUST BE INSTALLED AFTER SYDNEY WATER SEWERAGE LINES HAVE BEEN INSTALLED WHERE SEWER IS PROPOSED ADJACENT TO INTERALLOTMENT DRAINAGE LINES.
- S10 1% AEP OVERLAND FLOW PATHS MUST BE FORMED AND SHOWN ON 'WORKS AS EXECUTED' DRAWINGS.
- S12 ADEQUATE PROVISION IS TO BE MADE TO PREVENT SCOURING AND SEDIMENTATION FOR ALL DRAINAGE WORKS IN ACCORDANCE WITH COUNCIL'S REQUIREMENTS.
- S13 CATCH DRAINS MUST BE CONSTRUCTED AS REQUIRED BY THE APPROVED PLANS OR THE PRINCIPAL CERTIFYING AUTHORITY.
- S14 SOIL AND WATER MANAGEMENT PLANS ARE TO BE PREPARED FOR ALL DISTURBED SITES AND ADHERED TO AT ALL TIMES DURING THE CONSTRUCTION AND MAINTENANCE PERIODS.

LEGEND

DESCRIPTION	PROPOSED	EXISTING	FUTURE
STORMWATER PIPELINE			
STORMWATER DRAINAGE PITS			
DRAINAGE LINE No. 3 DRAINAGE PIT No. 10			
CONCRETE HEADWALL			
SUBSOIL DRAIN			
STANDARD 150mm KERB AND GUTTER			
STANDARD ROLL KERB AND GUTTER			
STANDARD KERB ONLY			
STANDARD EDGE STRIP			
STANDARD MOUNTABLE KERB			
STANDARD DISH CROSSING			
VEHICULAR CROSSING			
PEDESTRIAN RAMP			
EDGE OF BITUMEN			
ROAD PAVEMENT			
BENCHMARK			
BATTERS			
CONCRETE PATHWAY			
CONTOURS			
SITE REGRADING AREA			
SERVICE LINES SEWER, GAS, WATER, ELECTRICITY			
COMMUNICATION LINES TELSTRA, FIBRE OPTIC			
OVER HEAD LINES AND POLES			
SERVICE PITS TELECOM PIT, ACCESS CHAMBER, HYDRANT, STOP VALVE, AIR VALVE			
LIMIT OF CONSTRUCTION			
LIMIT OF STAGE			
FENCE POST AND RAIL FENCE SECURITY FENCE			
LOT NUMBERS			
TREES TO RETAIN			
TREES TO REMOVE			
RETAINING WALL			
BATTER AREA			

CONCEPT DESIGN

FILE: X11295.DWG: 1. BOX HILL - MT CARMEL ROAD/UTILITY DRAINAGE/PROPOSED/1.1285.01.01.DWG PRINTED: 4/2/14 USER: JONATHAN COULSONS

Revisions									
00	MG	JP			17/04/2014	ISSUED FOR SUBMISSION			
First Issue	JP	JP							
Drawn	Design	Check	Appd.	Date		Revision Details			

Disclaimer and Copyright:
ALL DIMENSIONS TO BE CHECKED ON SITE BY CONTRACTOR PRIOR TO CONSTRUCTION. USE WRITTEN DIMENSIONS ONLY, DO NOT SCALE.

CONSULT AUSTRALIA
Member Firm

Quality System
Quality Endorsed Company

Approval:
BY: STUART GREEN
FIEAust. CPEng. Manager – Urban Development
SIGN:

DATE: 17.4.14

Client:
MOGUL STUD/JUNDU PTY LTD

Project:
MT CARMEL ROAD
BOX HILL - MT CARMEL ROAD

BROWN
Smart Consulting
©2014 www.brownconsulting.com.au

Drawing Title:
GENERAL NOTES & LEGEND

Project No.: X11295.01 Stage: CD Milestone: 001 Dwg No.: 00 Revision:

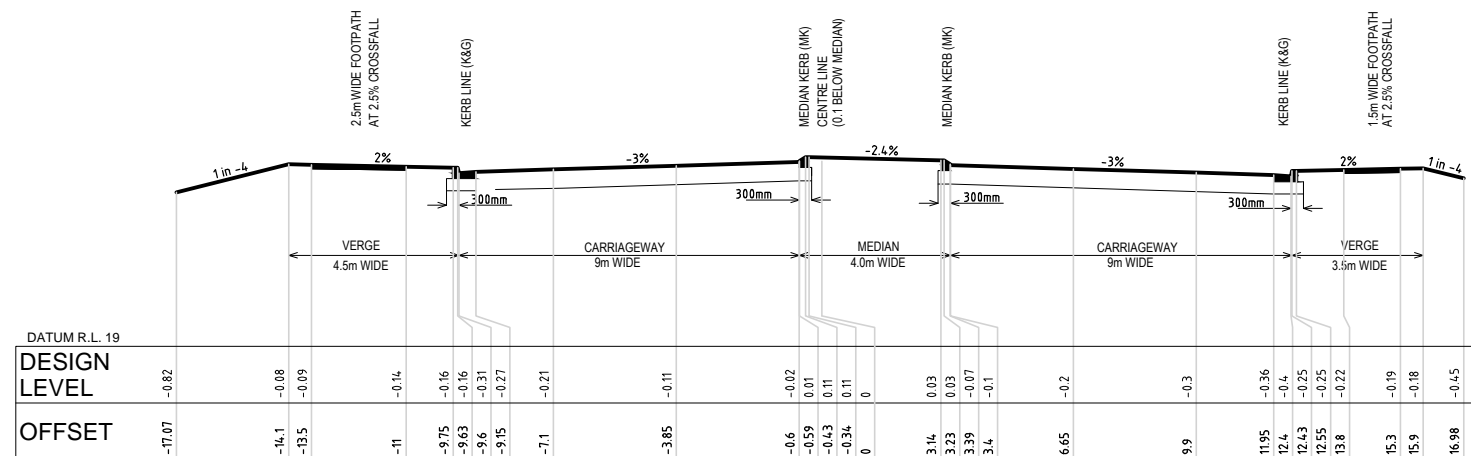

TYPICAL CROSS SECTION
MT CARMEL ROAD BETWEEN WINDSOR RD AND
KILARNEY CHAIN OF PONDS

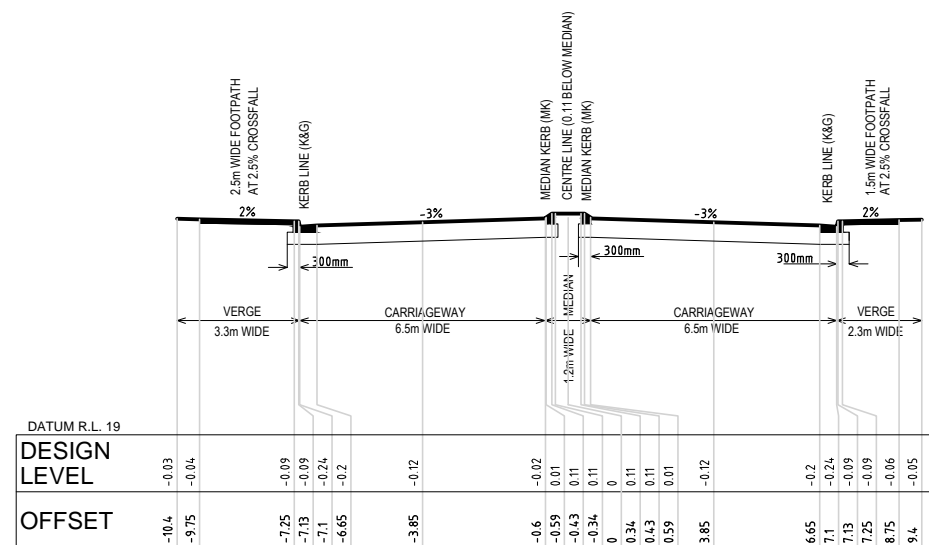

TYPICAL CROSS SECTION
MT CARMEL ROAD BRIDGE SECTION
SCALE 1:100 (H) 1:100 (V)

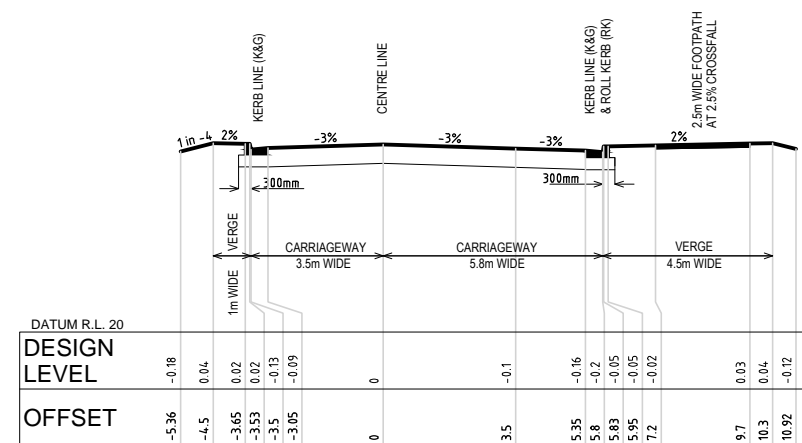

TYPICAL CROSS SECTION
MT CARMEL ROAD NORTH OF KILARNEY CHAIN OF
PONDS
SCALE 1:100 (H) 1:100 (V)

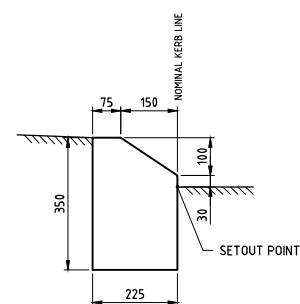

KERB TYPE
MOUNTABLE KERB (MK)
SCALE 1:10

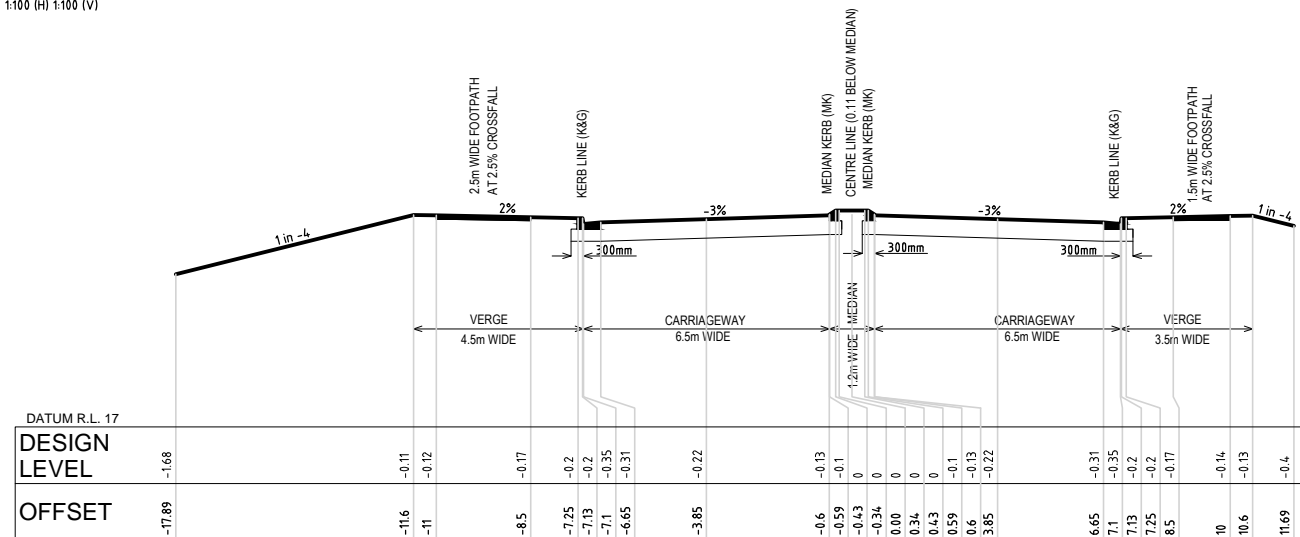

TYPICAL CROSS SECTION
MT CARMEL ROAD 1.2m WIDE MEDIAN
SCALE 1:100 (H) 1:100 (V)

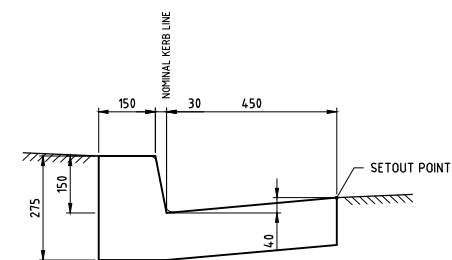

KERB TYPE
KERB AND GUTTER
SCALE 1:10

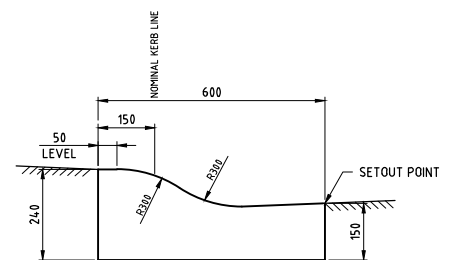

ROLL KERB AND GUTTER

SCALE 1:10

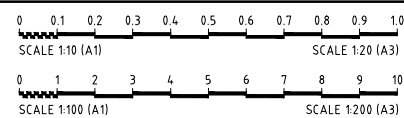
[illegible]

Disclaimer and Copyright:
ALL DIMENSIONS TO BE CHECKED ON SITE BY
CONTRACTOR PRIOR TO CONSTRUCTION. USE
WRITTEN DIMENSIONS ONLY, DO NOT SCALE.



© Brown Consulting Pty Ltd

Approval:
BY: **STUART GREEN**
FIEAust. CPEng, Manager – Urban
Development

DATE: 17.4.14

Client:	
---------	--

MOGUL STUD/JUNDU PTY LTD

Project

MT CARMEL ROAD
BOX HILL - MT CARMEL ROAD



Drawing Title:
TYPICAL CROSS SECTIONS

Project No.:	Stage:	Milestone:	Dwg No.:	Revision:
X11295.01		CD	002	00

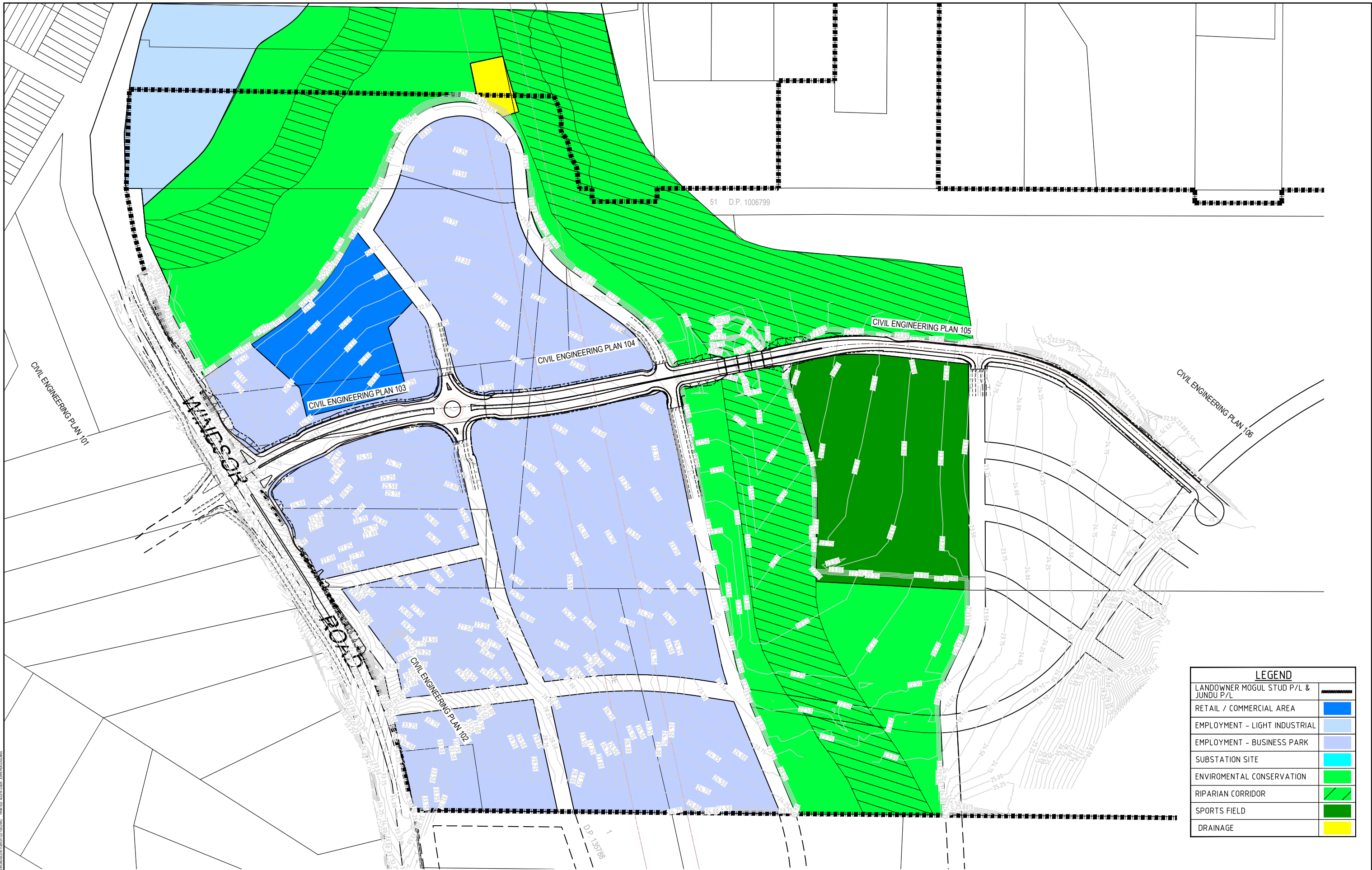

LEGEND	
LANDOWNER MOGUL STUD P/L & JUNDU P/L	
RETAIL / COMMERCIAL AREA	
EMPLOYMENT - LIGHT INDUSTRIAL	
EMPLOYMENT - BUSINESS PARK	
SUBSTATION SITE	
ENVIROMENTAL CONSERVATION	
RIPARIAN CORRIDOR	
SPORTS FIELD	
DRAINAGE	

CONCEPT DESIGN

Revisions						
00	MG	JP			17/04/2014	ISSUED FOR SUBMISSION
First Issue	Drawn	Design	Check	Appd.	Date	Revision Details

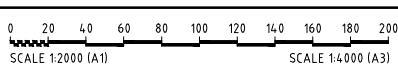

Disclaimer and Copyright:
ALL DIMENSIONS TO BE CHECKED ON SITE BY
CONTRACTOR PRIOR TO CONSTRUCTION. USE
WRITTEN DIMENSIONS ONLY, DO NOT SCALE.



Approval:
BY: STUART GREEN
FIEAust. CPEng. Manager - Urban
Development
SIGN:
DATE: 17.4.14

Client:
MOGUL STUD/JUNDU PTY LTD
Project:
MT CARMEL ROAD
BOX HILL - MT CARMEL ROAD



Drawing Title: GENERAL LAYOUT PLAN				
Project No.: X11295.01	Stage: CD	Milestone: 100	Dwg No.: 100	Revision: 00

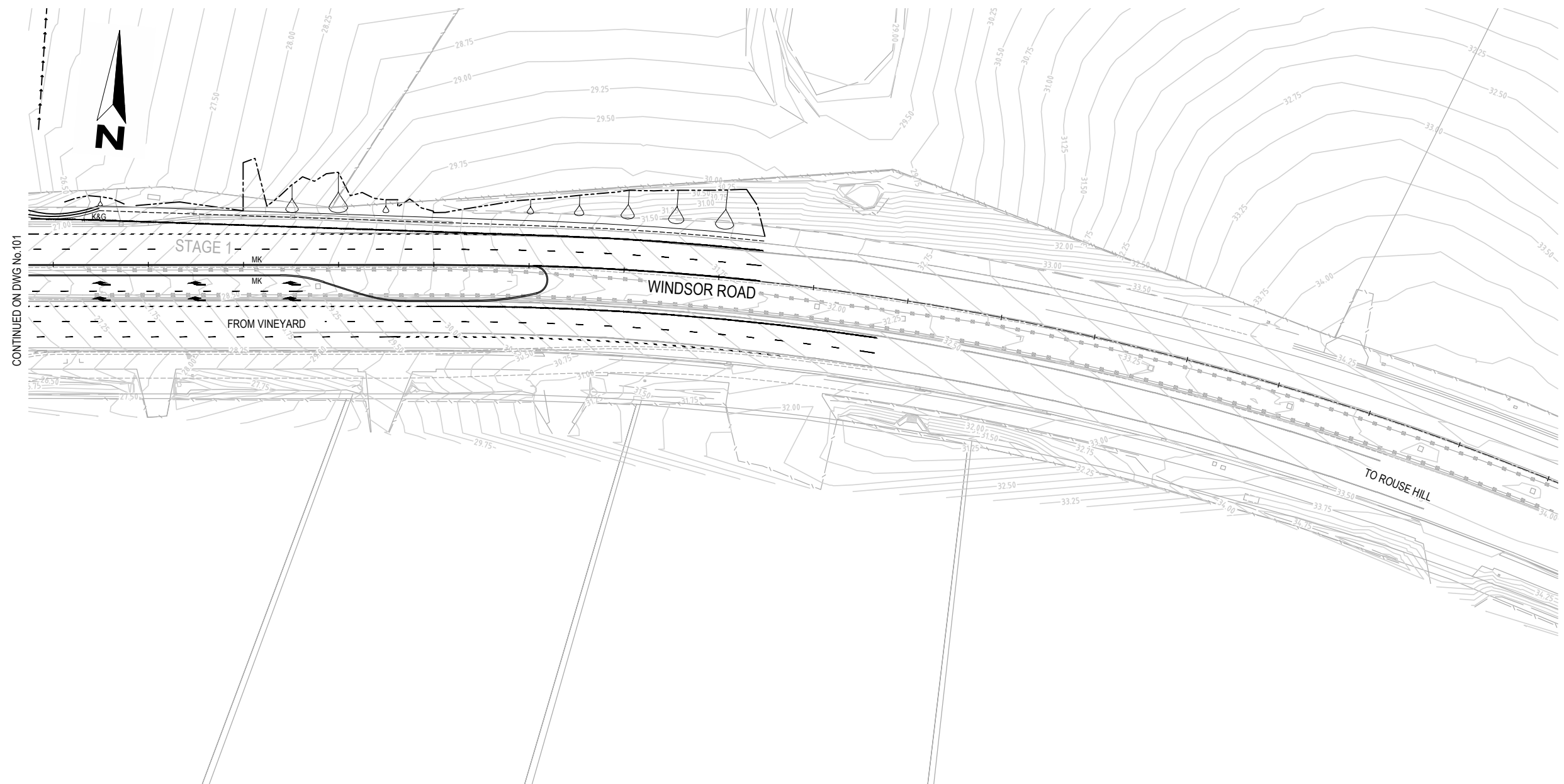

CONCEPT DESIGN

Revisions						
00	MG	JP		17/04/2014	ISSUED FOR SUBMISSION	
First	JP	JP				
Issue	Drawn	Design	Check	Appd.	Date	Revision Details

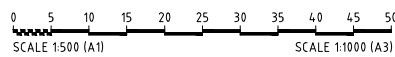

Disclaimer and Copyright:
ALL DIMENSIONS TO BE CHECKED ON SITE BY
CONTRACTOR PRIOR TO CONSTRUCTION. USE
WRITTEN DIMENSIONS ONLY, DO NOT SCALE.



© Brown Consulting Pty Ltd

Approval:
BY: **STUART GREEN**
FIEAust. CPEng. Manager - Urban
Development
SIGN:

DATE: **17.4.14**

Client:
MOGUL STUD/JUNDU PTY LTD
Project:
**MT CARMEL ROAD
BOX HILL - MT CARMEL ROAD**



Drawing Title: ENGINEERING PLAN SHEET 2 OF 6				
Project No.: X11295.01	Stage: CD	Milestone: 102	Dwg No.: 00	Revision: 00

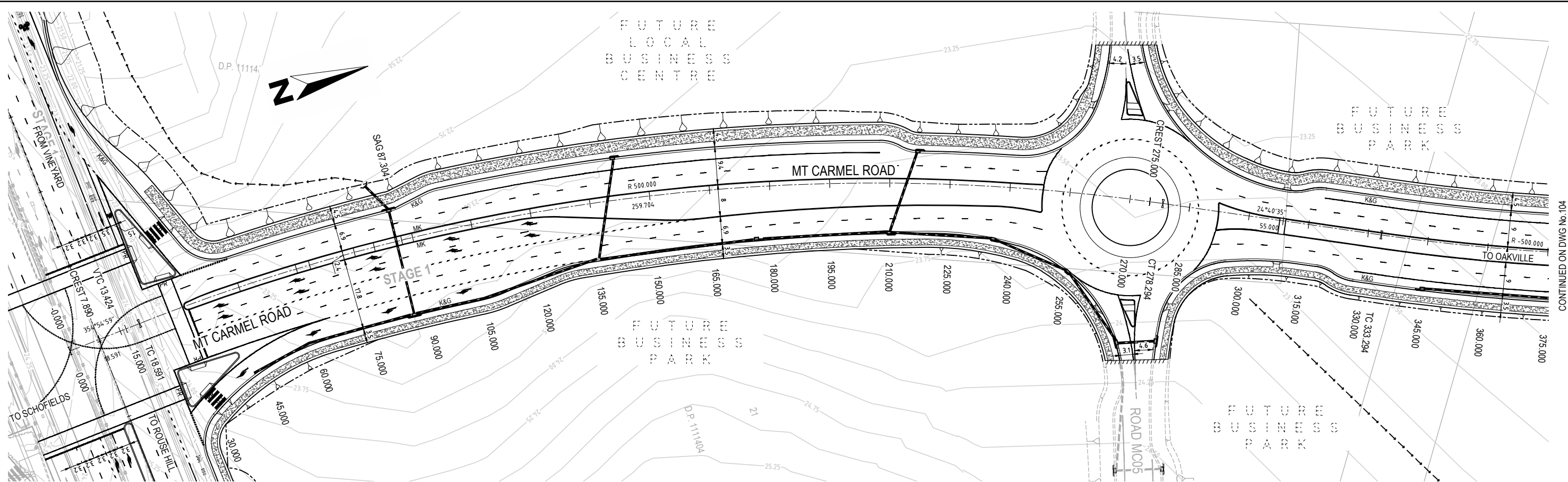

CONTINUED ON DWG No. 104

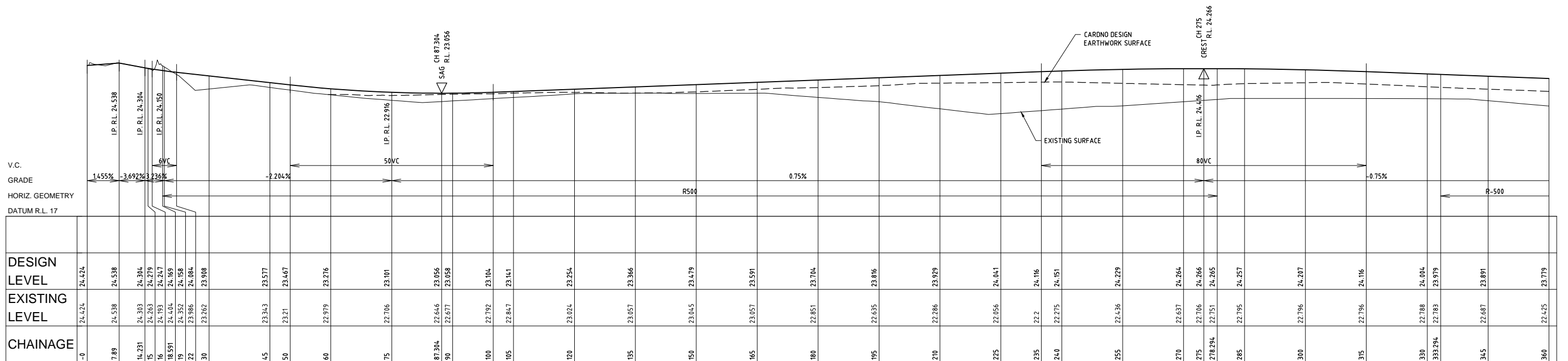

LONGITUDINAL SECTION CENTRELINE - MC02

SCALE 1:500 (H)
SCALE 1:100 (V)

CONCEPT DESIGN

Revisions					
00	MG	JP		17/04/2014	ISSUED FOR SUBMISSION
First Issue	Drawn	Design	Check	Appd.	Date
Revision Details					

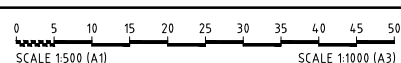

Disclaimer and Copyright:
ALL DIMENSIONS TO BE CHECKED ON SITE BY
CONTRACTOR PRIOR TO CONSTRUCTION. USE
WRITTEN DIMENSIONS ONLY, DO NOT SCALE.



© Brown Consulting Pty Ltd



Approval:
BY: STUART GREEN
FIEAust. CPEng. Manager - Urban
Development
SIGN:
DATE: 17.4.14

Client:
MOGUL STUD/JUNDU PTY LTD
Project:
**MT CARMEL ROAD
BOX HILL - MT CARMEL ROAD**



Drawing Title:
ENGINEERING PLAN SHEET 3 OF 6
Project No.: X11295.01
Stage: CD
Milestone: 103
Dwg No.: 00
Revision: 00

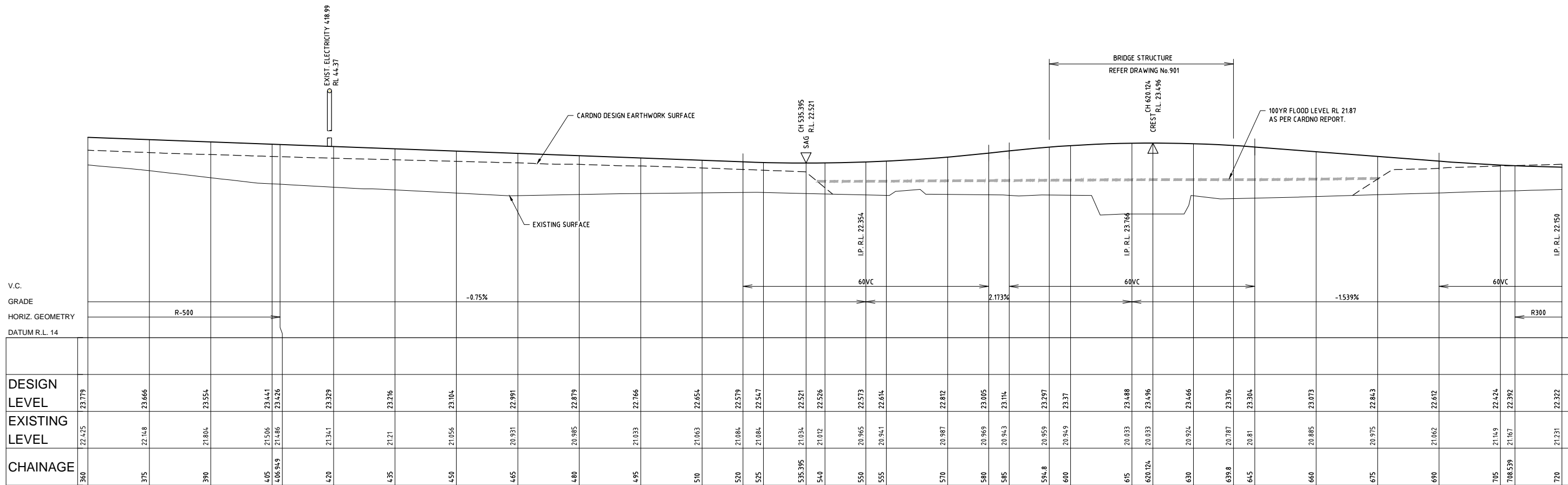
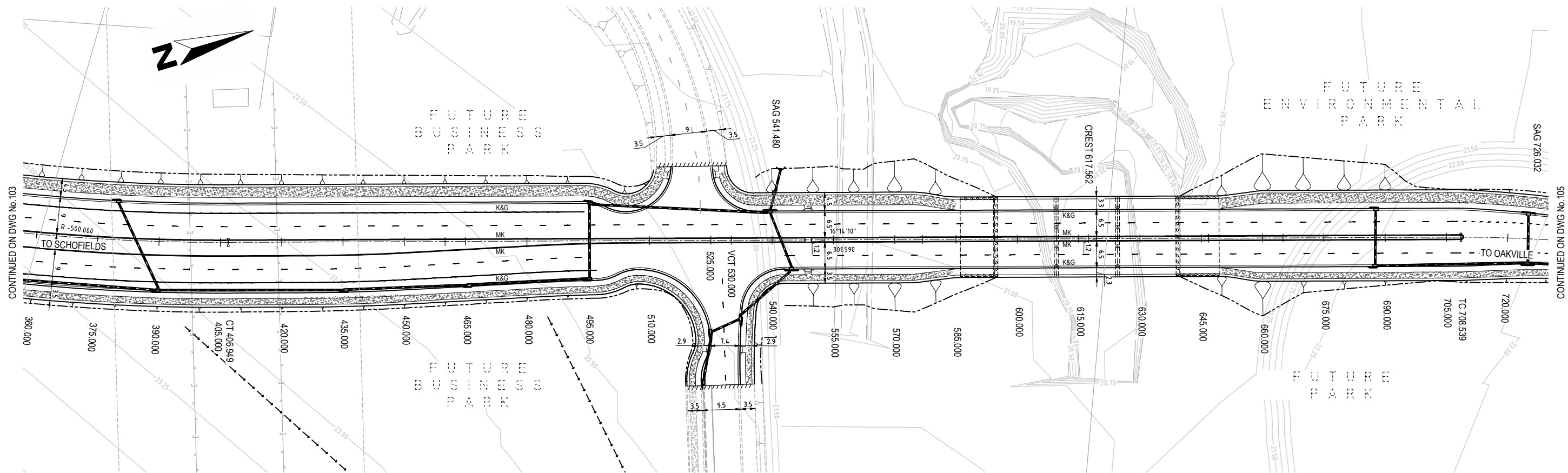

LONGITUDINAL SECTION CENTRELINE - MC02

SCALE 1:500 (H)
SCALE 1:100 (V)

CONCEPT DESIGN

Revisions					
00	MG	JP		17/04/2014	ISSUED FOR SUBMISSION
First Issue	Drawn	Design	Check	Appd.	Date
Revision Details					

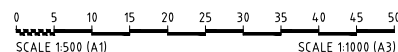

Disclaimer and Copyright:
ALL DIMENSIONS TO BE CHECKED ON SITE BY CONTRACTOR PRIOR TO CONSTRUCTION. USE WRITTEN DIMENSIONS ONLY, DO NOT SCALE.

CONSULT AUSTRALIA
Member Firm

Approval:
BY: STUART GREEN
FIEAust. CPEng. Manager - Urban Development
SIGN: [Signature]
DATE: 17.4.14

Client:
MOGUL STUD/JUNDU PTY LTD
Project:
MT CARMEL ROAD
BOX HILL - MT CARMEL ROAD



Drawing Title:
ENGINEERING PLAN SHEET 4 OF 6
Project No.: X11295.01
Stage: CD
Milestone: 104
Dwg No.: 00
Revision: 00

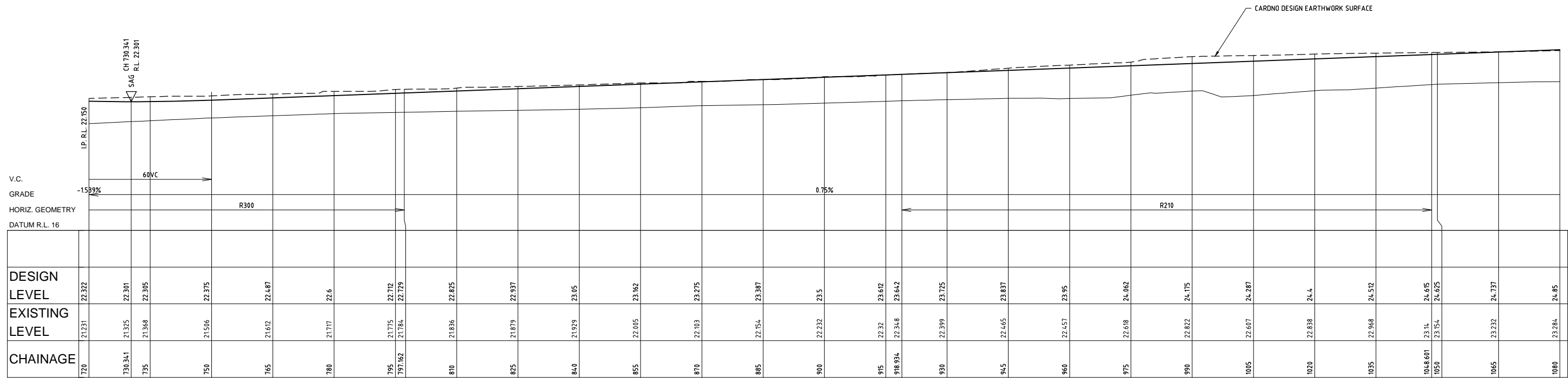
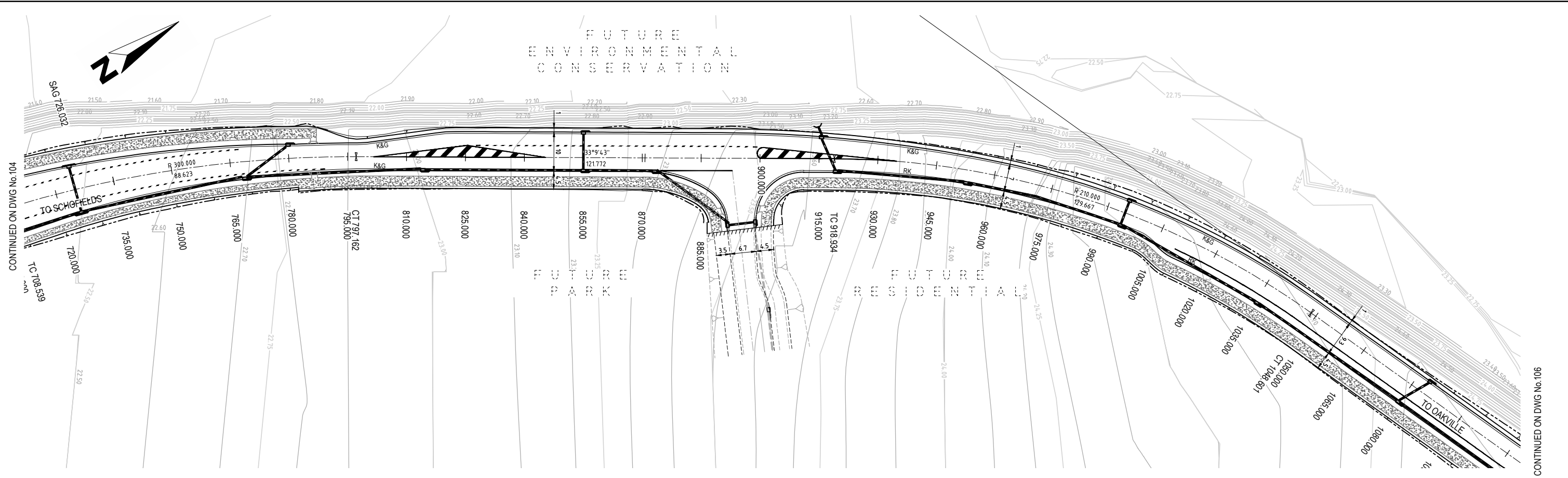

LONGITUDINAL SECTION CENTRELINE - MC02

SCALE 1:500 (H)
SCALE 1:100 (V)

CONCEPT DESIGN

Revisions				
00	MG	JP		17/04/2014
First Issue	Drawn	Design	Check	Appd.
Revision Details				

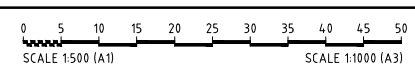

Disclaimer and Copyright:
ALL DIMENSIONS TO BE CHECKED ON SITE BY CONTRACTOR PRIOR TO CONSTRUCTION. USE WRITTEN DIMENSIONS ONLY, DO NOT SCALE.

CONSULT AUSTRALIA
Member Firm

Approval:
BY: STUART GREEN
FIEAust. CPEng. Manager - Urban Development
SIGN: [Signature]
DATE: 17.4.14

Client:
MOGUL STUD/JUNDU PTY LTD

Project:
MT CARMEL ROAD
BOX HILL - MT CARMEL ROAD



Drawing Title: ENGINEERING PLAN SHEET 5 OF 6				
Project No.: X11295.01	Stage: CD	Milestone: 105	Dwg No.: 105	Revision: 00

FILE: H:\PROJECTS\11 BOX HILL MT CARMEL RD\ENVIRONMENTAL\DRAWINGS\BOX HILL MT CARMEL RD CD 106.DWG PRINTED: 4/2/14 USER: JONATHAN COLLINGS

Revisions						
00	MG	JP		17/04/2014	ISSUED FOR SUBMISSION	
First	JP	JP				
Issue	Drawn	Design	Check	Appd.	Date	Revision Details



Disclaimer and Copyright:
ALL DIMENSIONS TO BE CHECKED ON SITE BY
CONTRACTOR PRIOR TO CONSTRUCTION. USE
WRITTEN DIMENSIONS ONLY, DO NOT SCALE.

CONSULT AUSTRALIA
Member Firm

Quality System
Quality
Endorsed
Company

© Brown Consulting Pty Ltd

Approval:
BY: STUART GREEN
FIEAust. CPEng. Manager - Urban
Development
SIGN:
DATE: 17.4.14

Client:
MOGUL STUD/JUNDU PTY LTD

Project:
MT CARMEL ROAD
BOX HILL - MT CARMEL ROAD



Drawing Title:
ENGINEERING PLAN SHEET 6 OF 6

Project No.: X11295.01 Stage: CD Milestone: 106 Revision: 00

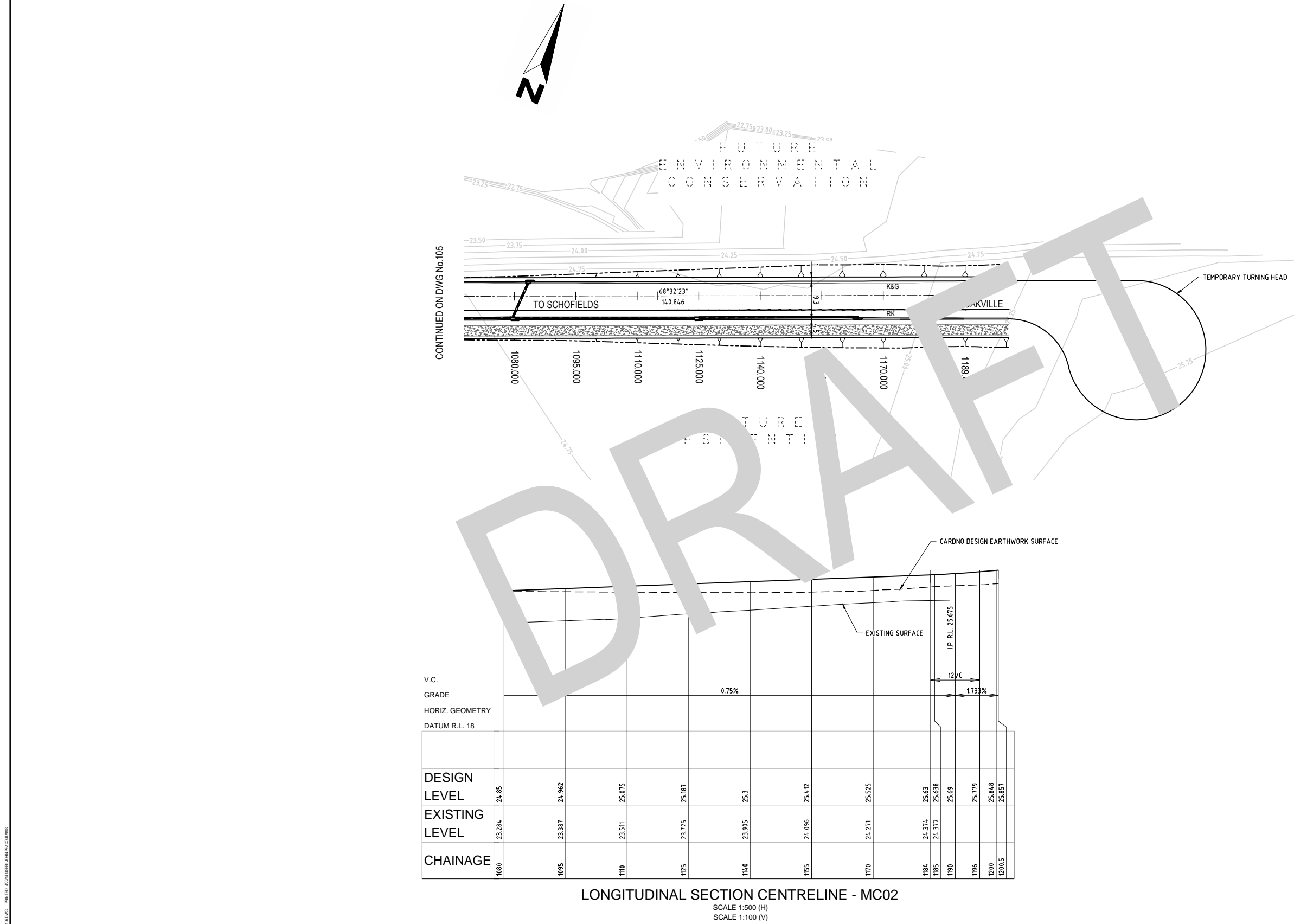

CONCEPT DESIGN

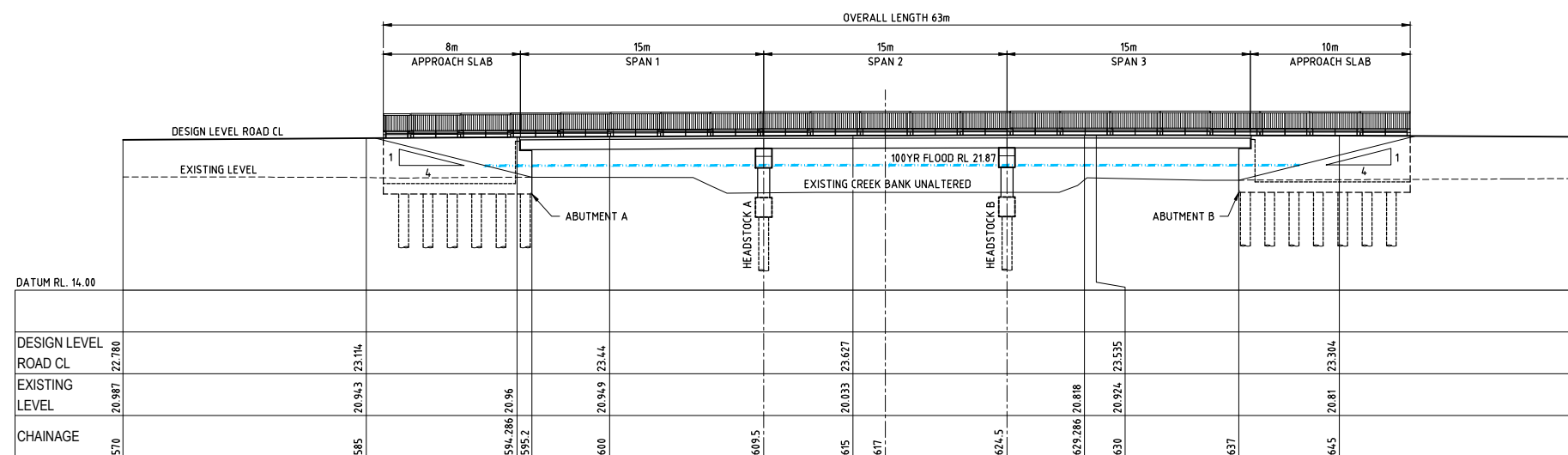
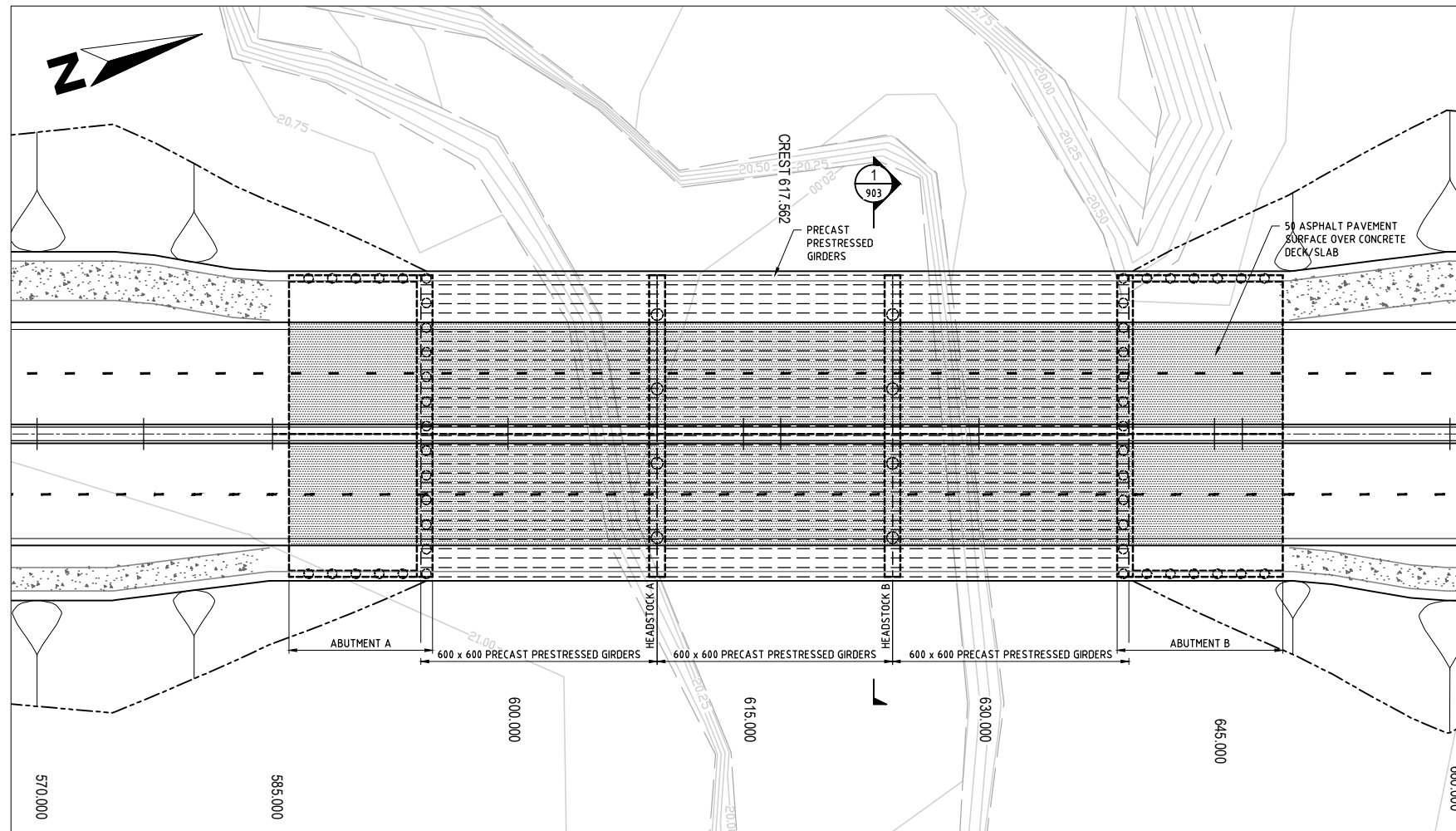

CONCEPT DESIGN

FILE: H:\MT CARMEL RD\BOX HILL MT CARMEL RD\CONCEPT DESIGN\BRIDGE\CD 001.DWG - PRINTED: 4/2/2014 USER: JONATHAN COULSON

Revisions						
00	MG	JP		17/04/2014	ISSUED FOR SUBMISSION	
First Issue	Drawn	Design	Check	Appd.	Date	Revision Details

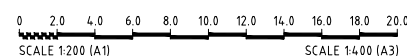

Disclaimer and Copyright:
ALL DIMENSIONS TO BE CHECKED ON SITE BY
CONTRACTOR PRIOR TO CONSTRUCTION. USE
WRITTEN DIMENSIONS ONLY, DO NOT SCALE.

CONSULT AUSTRALIA
Member Firm

© Brown Consulting Pty Ltd



Approval:
BY: STUART GREEN
FIE Aust. CP Eng. Manager - Urban
Development
SIGN:
DATE: 17.4.14

Client:
MOGUL STUD/JUNDU PTY LTD

Project:
MT CARMEL ROAD
BOX HILL - MT CARMEL ROAD



Drawing Title:
STRUCTURAL BRIDGE LAYOUT -
OPTION 1

Project No.: X11295.01	Stage: CD	Milestone: 901	Dwg No.: 00	Revision:
---------------------------	--------------	-------------------	----------------	-----------

Project No.:	Stage:	Milestone:	Dwg No.:	Revision:
X11295.01		CD	903	00